

SPACE 720 LOD

SCALE: 1/8" = 1'-0"

TOTAL SF:	1,750 SF
STOCK/STORAGE SF:	350 SF (20% OF TOTAL SF)
OCCUPANT LOAD:	23 OCCUPANTS
EGRESS WIDTH REQUIRED:	4.6"

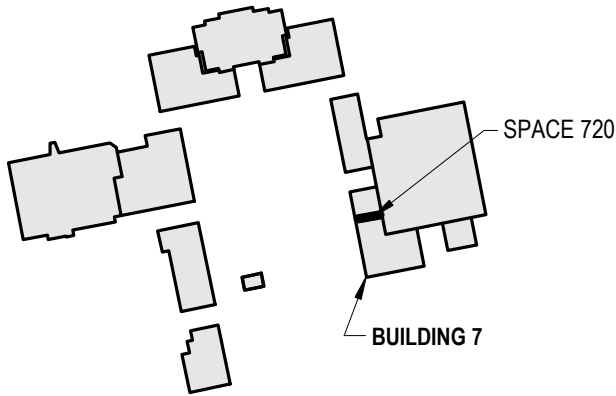

KEYPLAN BLDG 7

Bowen⁺

2019 Center St, Suite 500 Cleveland, Ohio 44113 Phone: (216) 491-9300 www.rlba.com

HANOVER CROSSING BUILDING 6 & 7

1775 Washington St, Hanover, MA 02339

RLB+A JOB#: 8838.13

SCALE: 1/8" = 1'-0"

ISSUED FOR:
ADDENDUM #

DATE:
09/29/22

DRAWING NO.

LOD
720 - SK01

THIS ARCHITECTURAL AND ENGINEERING DRAWING IS GIVEN IN CONFIDENCE. NO USE OR DISSEMINATION MAY BE MADE WITHOUT PRIOR WRITTEN CONSENT OF THE ARCHITECT. ALL RIGHTS ARE HEREBY SPECIFICALLY RESERVED. © 2022 RICHARD L. BOWEN + ASSOCIATES, INC.