

Town of Hanover - MUNICIPAL FACILITIES ASSESSMENT - 2010
Section 08 - Sylvester Elementary School
FLOOR PLAN

D·R·A
 Page 08-12

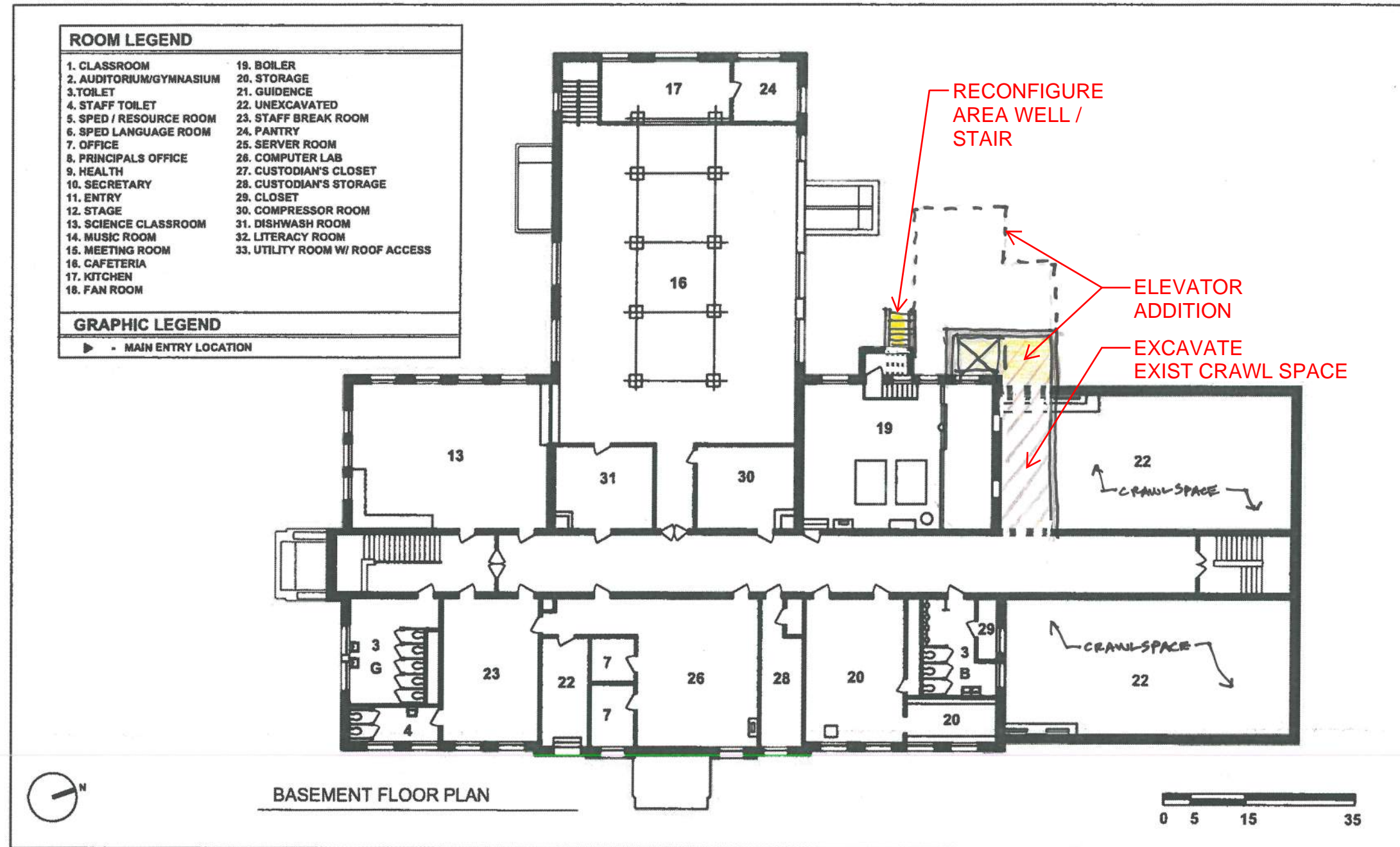

D·R·A

**Drumey
 Rosane
 Anderson
 Inc.**

Architecture
 Interior Design

Colby Hall
 141 Herrick Road
 Newton Centre, MA
 02459

617-964-1700
 617-969-9054 fax

**SYLVESTER SCHOOL
 TOWN BUILDING STUDY**
 Hanover, Massachusetts

Scale: SEE BAR SCALE

Drawn by: E.J.L.

Job# 09017.00

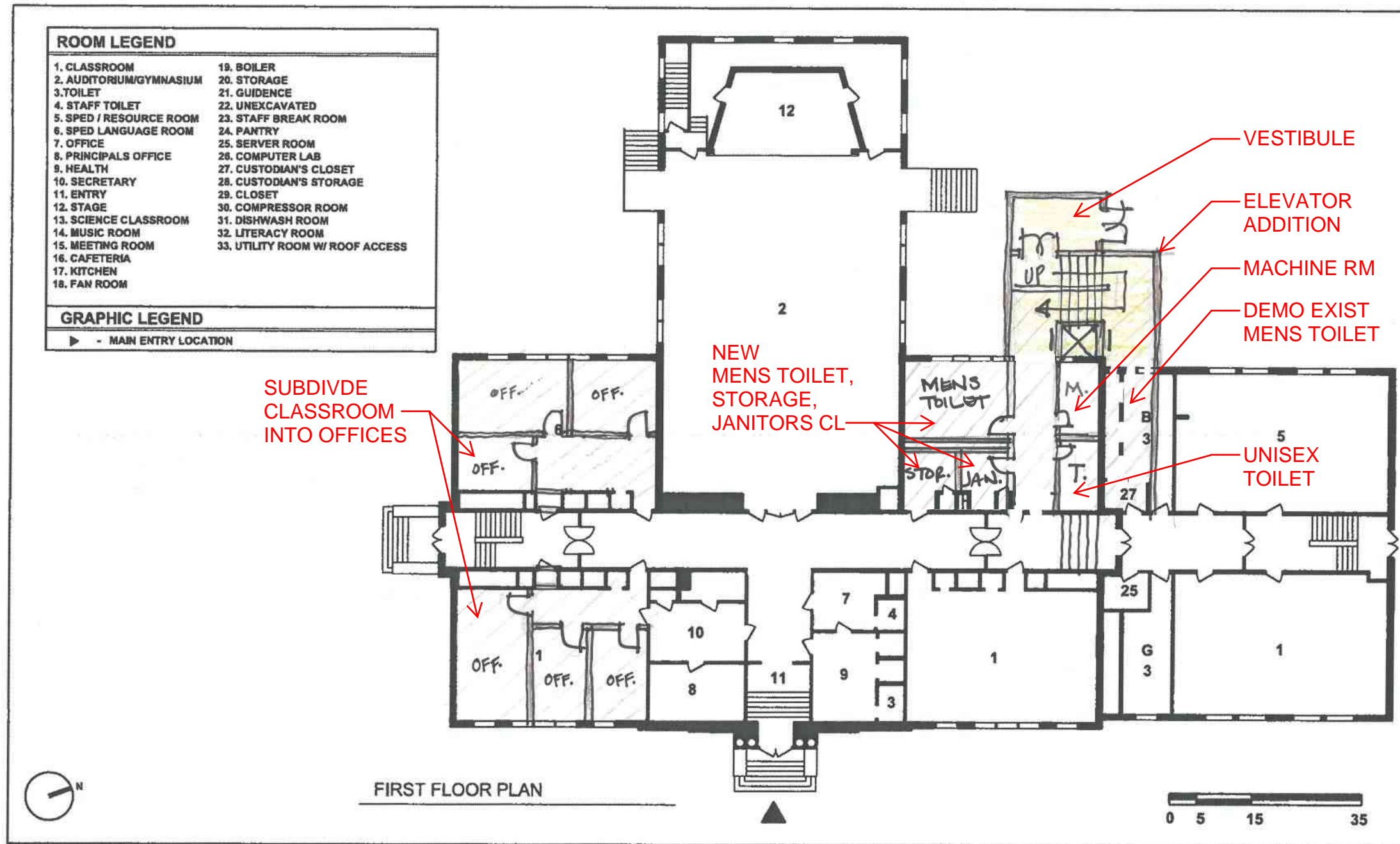

FLOOR PLAN

D.R.A.

Drumey
 Rosane
 Anderson
 Inc.

Architecture
 Interior Design

Colby Hall
 141 Herrick Road
 Newton Centre, MA
 02459

617-964-1700
 617-969-9054 fax

SYLVESTER SCHOOL TOWN BUILDING STUDY Hanover, Massachusetts

Scale:SEE BAR SCALE

Drawn by: MJQ

Job# 09017.00

Town of Hanover - MUNICIPAL FACILITIES ASSESSMENT - 2010
 Section 08 - Sylvester Elementary School

FLOOR PLAN

D.R.A.
 Page 08-14

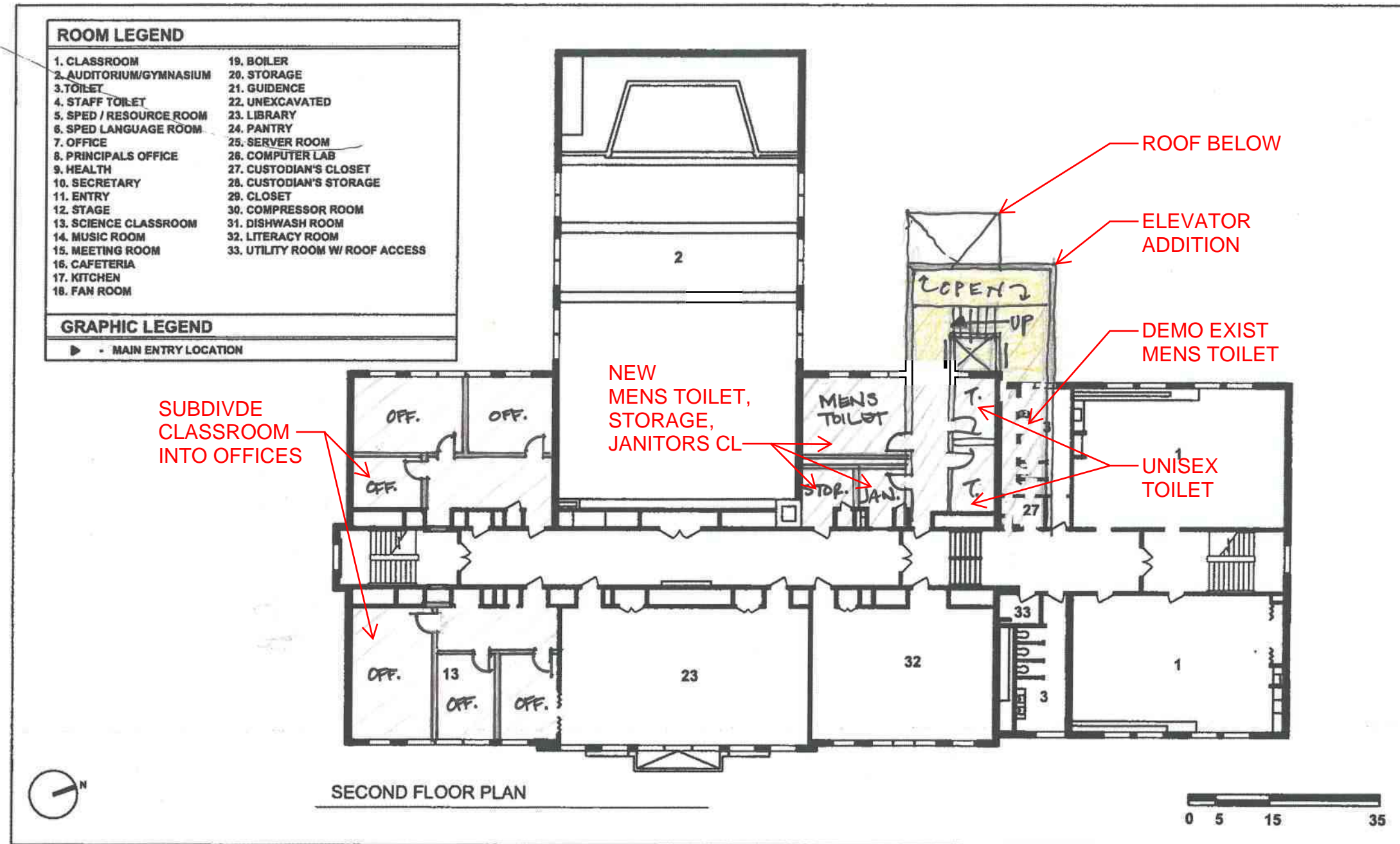

D.R.A.

**Drumey
 Rosane
 Anderson
 Inc.**

Architecture
 Interior Design

Colby Hall
 141 Herrick Road
 Newton Centre, MA
 02459

617-964-1700
 617-969-9054 fax

**SYLVESTER SCHOOL
 TOWN BUILDING STUDY**
 Hanover, Massachusetts

Scale: SEE BAR SCALE

Drawn by: E.J.L.

Job# 09017.00